

QTY REQ'D	ITEM NO.	REF DES	CAGE NO.	PART OR IDENTIFYING NO.	NOMENCLATURE OR DESCRIPTION	SPECIFICATION	MATERIAL OR NOTE	ZONE
1	4		10-012	IRTF_Optics holder two_v1 part 2			AL 6061	
1	3		10-019	IRTF_Optics holder two_v1			AL 6061	
1	2		10-018	IRTF_Optics holder one_v1 part 1			AL 6061	
1	1		10-017	IRTF_Optics holder part 1 v2			AL 6061	

PARTS LIST

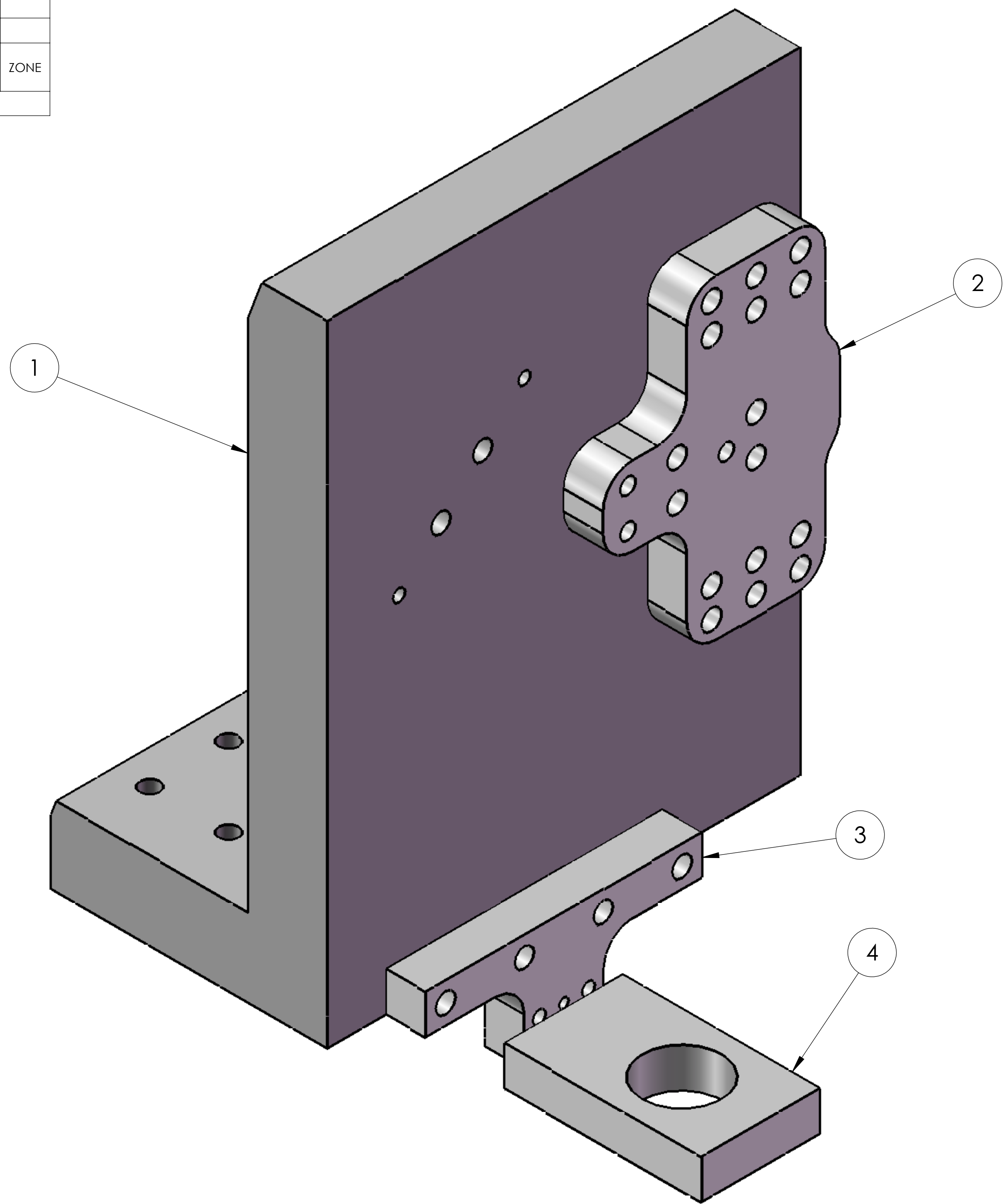

- 3. FIT TO ASSEMBLY 10-010
- 2. ALIGN USING DOWELL PINS
- 1. REMOVE ALL BURRS AND SHARP EDGES .003 TO .010

NOTES: UNLESS OTHERWISE SPECIFIED

UNLESS OTHERWISE SPECIFIED DIMENSIONS ARE IN INCHES TOLERANCES DECIMALS .XX" ± .03 ANGLES .XXX" ± .010 ± 1/2		CONTRACT NO		<b>Folkers E. Rojas UROP Production</b> <i>Massachusetts Institute of Technology          Boston, MA 02139</i>	
MACHINE FINISH 32		APPVD F.E. Rojas DATE			
DO NOT SCALE DRAWING INTERPRET DWG BY ISO		CHK		<b>POETS on IRTF          Interior Hardware Assembly</b>	
MATERIAL		STRCT			
NEXT ASSEMBLY 10-999 USED ON		MATL		SCALE D CAGE NO 10-016 FILE: Sub-Assembly REV A	
APPLICATION		ENGR		SCALE 2/1 UNCLASSIFIED	
		DIGN SUPV			

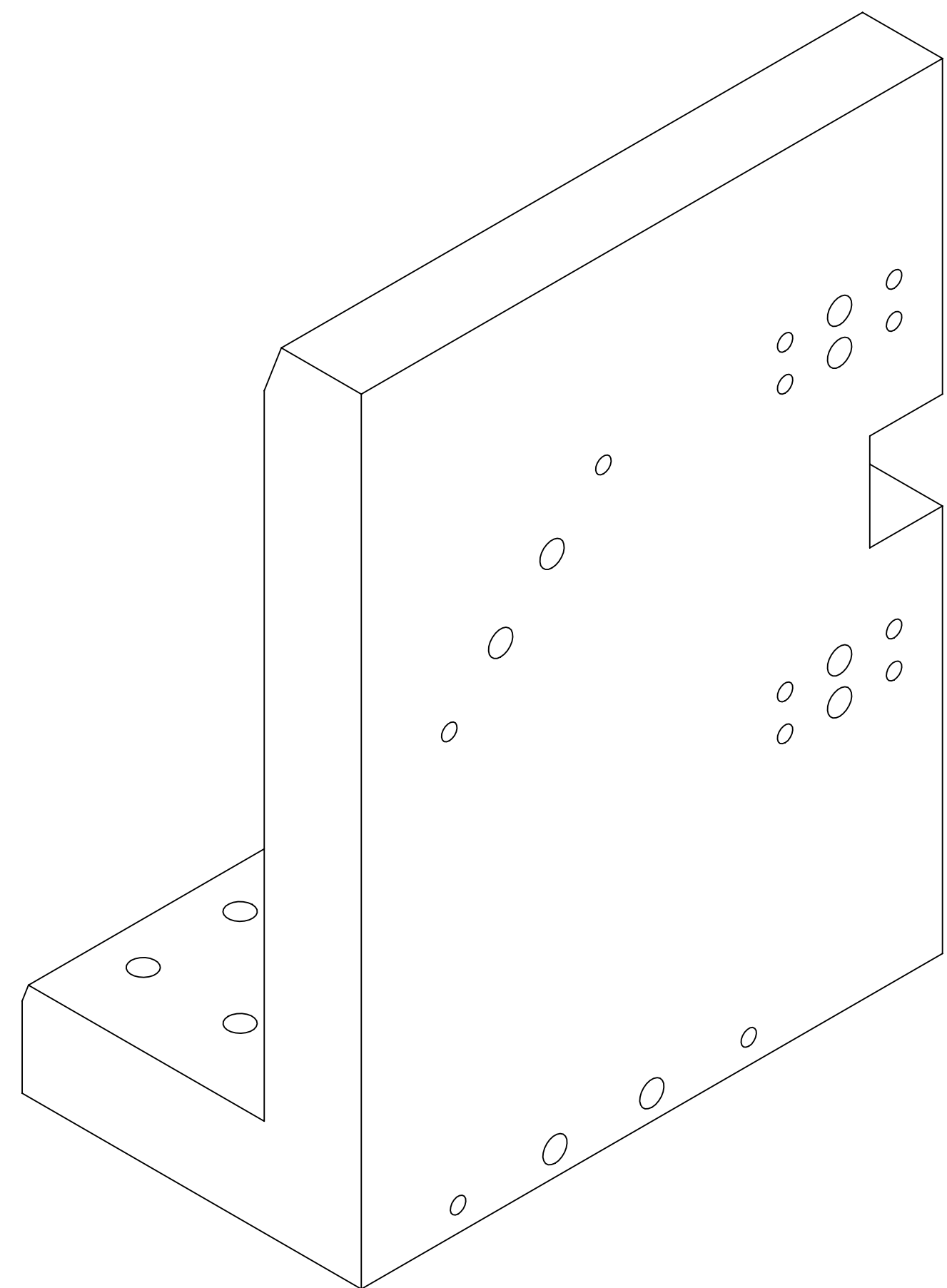

PROJECTED VIEW  
FOR REFERENCE ONLY  
DO NOT SCALE

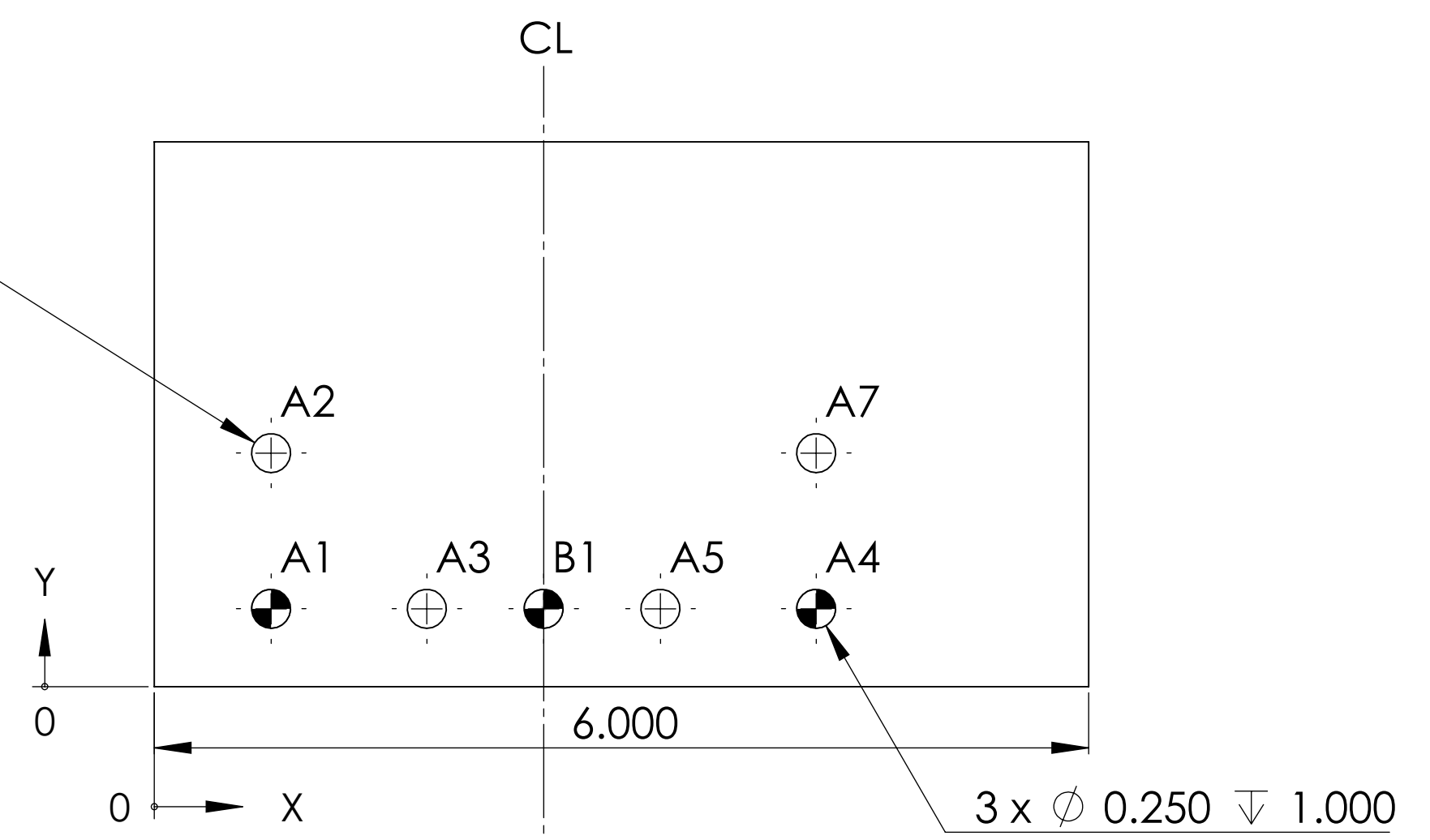
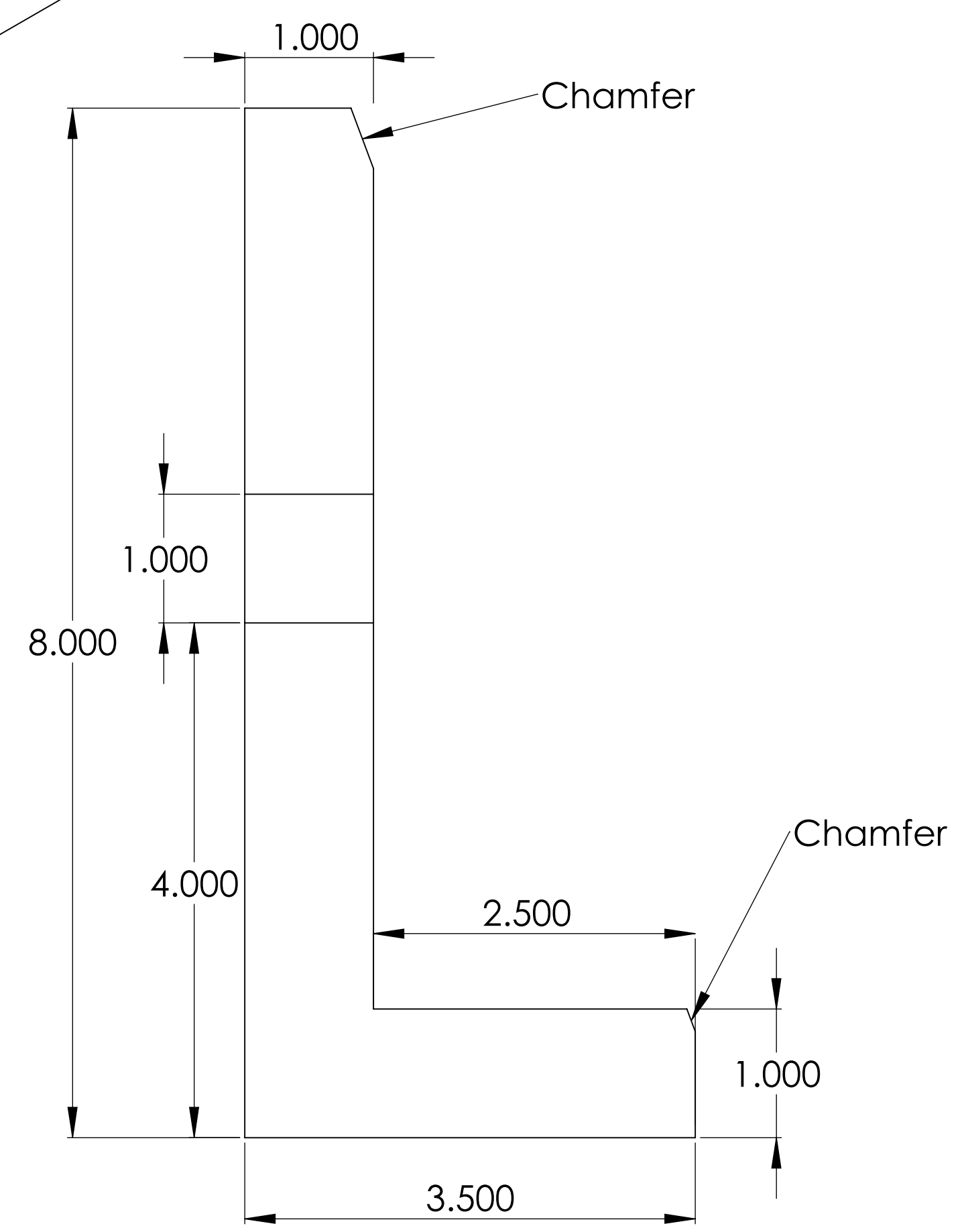

TAG	X LOC	Y LOC	SIZE
A1	0.750	0.500	Ø 0.250 ± 1.000
A2	0.750	1.500	1/4-20 CLEARANCE
A3	1.750	0.500	1/4-20 CLEARANCE
B1	2.500	0.500	Ø 0.250 ± 1.000
A5	3.250	0.500	1/4-20 CLEARANCE
A4	4.250	0.500	Ø 0.250 ± 1.000
A7	4.250	1.500	1/4-20 CLEARANCE

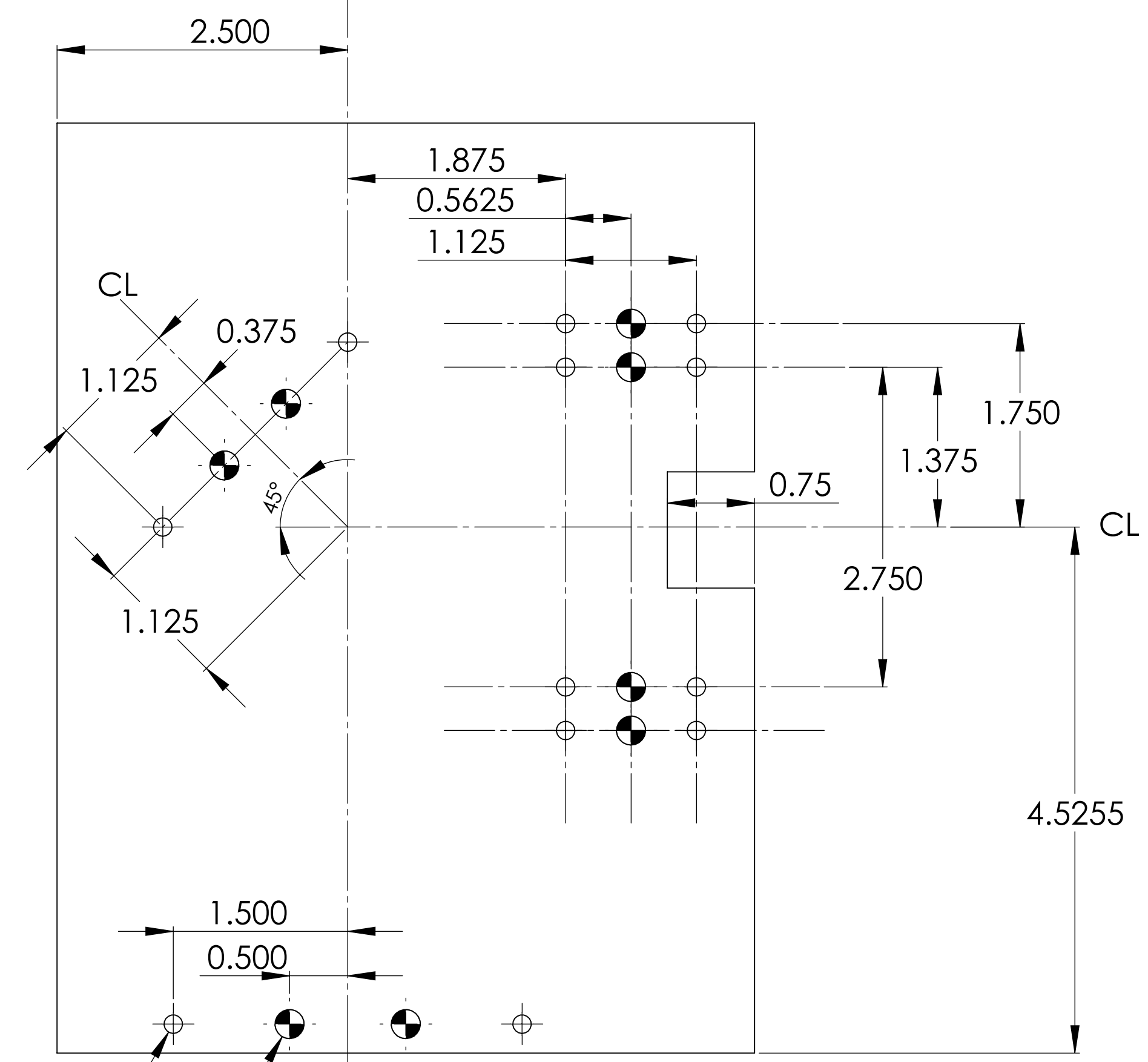

12 x Ø 0.159 ± 1.250  
10-32 UNF ± 0.380  
8 x Ø 0.250 ± 1.500

1. REMOVE ALL BURRS AND SHARP EDGES .003 TO .010

NOTES; UNLESS OTHERWISE SPECIFIED

UNLESS OTHERWISE SPECIFIED DIMENSIONS ARE IN INCHES TOLERANCES DECIMALS .XX" ± .03 .XXX" ± .010 ANGLES ± 1/2		CONTRACT NO		<b>Folkers E. Rojas UROP Production</b> <i>Massachusetts Institute of Technology Boston, MA 02139</i>	
MACHINE FINISH 32 DO NOT SCALE DRAWING INTERPRET DWG BY ISO		APPVD F.E. Rojas DATE			
MATERIAL AL 6061 USE CAST AL		DWN F.E. Rojas		<b>POETS on IRTF Interior Hardware: Stand</b>	
APPLICATION		CHK			
NEXT ASSEMBLY USED ON		STRCT		SCALE D	
		MATL		CAGE NO 10-017	
		THRM CONT		FILE: PART	
		ENGR		REV B	
		DSGN SUPV		SCALE 1/1 UNCLASSIFIED	

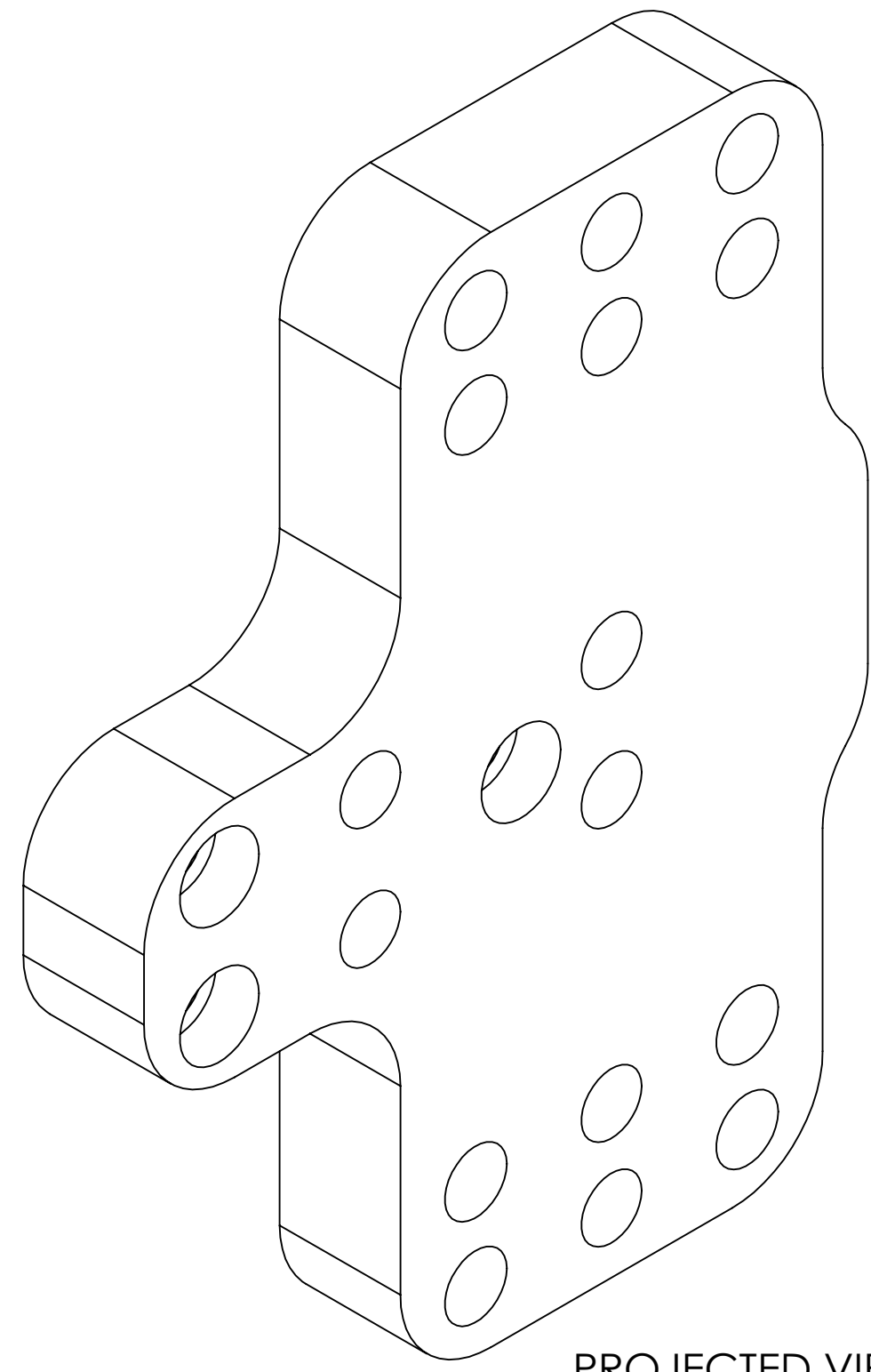

PROJECTED VIEW  
FOR REFERENCE ONLY  
DO NOT SCALE

TAG	X LOC	Y LOC	SIZE
A1	-1.625	-0.250	∅ 0.201 THRU ALL └┘ ∅ 0.328 ▽ 0.180
A2	-1.625	0.250	∅ 0.201 THRU ALL └┘ ∅ 0.328 ▽ 0.180
A3	-0.375	0.000	∅ 0.201 THRU ALL └┘ ∅ 0.328 ▽ 0.180
B1	-1.000	-0.250	∅ 0.250 ▽ 1.500
B2	-1.000	0.250	∅ 0.250 ▽ 1.500
B3	0.000	-1.750	∅ 0.250 ▽ 1.500
B4	0.000	-1.375	∅ 0.250 ▽ 1.500
B5	0.000	-0.250	∅ 0.250 ▽ 1.500
B6	0.000	0.250	∅ 0.250 ▽ 1.500
B7	0.000	1.375	∅ 0.250 ▽ 1.500
B8	0.000	1.750	∅ 0.250 ▽ 1.500
C1	-0.562	-1.750	∅ 0.257 ▽ 1.500
C2	-0.562	-1.375	∅ 0.257 ▽ 1.500
C3	-0.562	1.375	∅ 0.257 ▽ 1.500
C4	-0.562	1.750	∅ 0.257 ▽ 1.500
C5	0.563	-1.750	∅ 0.257 ▽ 1.500
C6	0.563	-1.375	∅ 0.257 ▽ 1.500
C7	0.563	1.375	∅ 0.257 ▽ 1.500
C8	0.563	1.750	∅ 0.257 ▽ 1.500

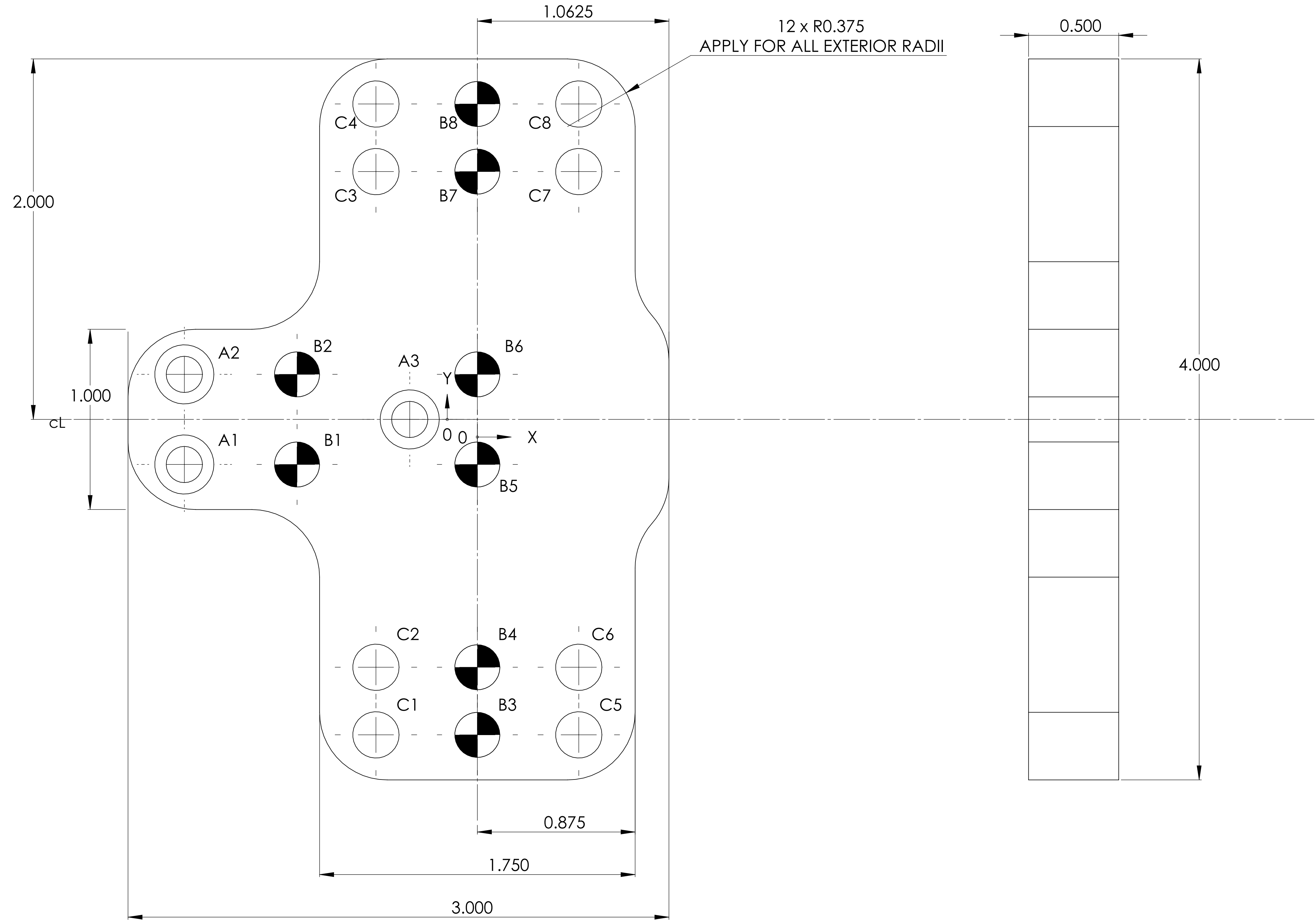

3. ALL EXTERNAL RADII .375
2. ALIGN USING DOWELL PINS TO PART 10-017
1. REMOVE ALL BURRS AND SHARP EDGES .003 TO .010

NOTES: UNLESS OTHERWISE SPECIFIED

UNLESS OTHERWISE SPECIFIED DIMENSIONS ARE IN INCHES TOLERANCES DECIMALS .XX" ± .03 ANGLES ±1/2 .XXX" ± .010		CONTRACT NO		<b>Folkers E. Rojas UROP Production</b> <i>Massachusetts Institute of Technology</i> <i>Boston, MA 02139</i>	
MACHINE FINISH 32 DO NOT SCALE DRAWING INTERPRET DWG BY ISO		APPVD F.E. Rojas DATE			
MATERIAL AL 6061 USE CAST AL		DWN		<b>POETS on IRTF</b> <b>Interior Hardware: Optic 1Stand</b>	
NEXT ASSEMBLY 10-016 USED ON		CHK			
APPLICATION		STRCT		SCALE D	
		MATL		CAGE NO 10-016	
		THRM CONT		FILE: PART	
		ENGR		REV B	
		DSGN SUPV		SCALE 3/1 UNCLASSIFIED	

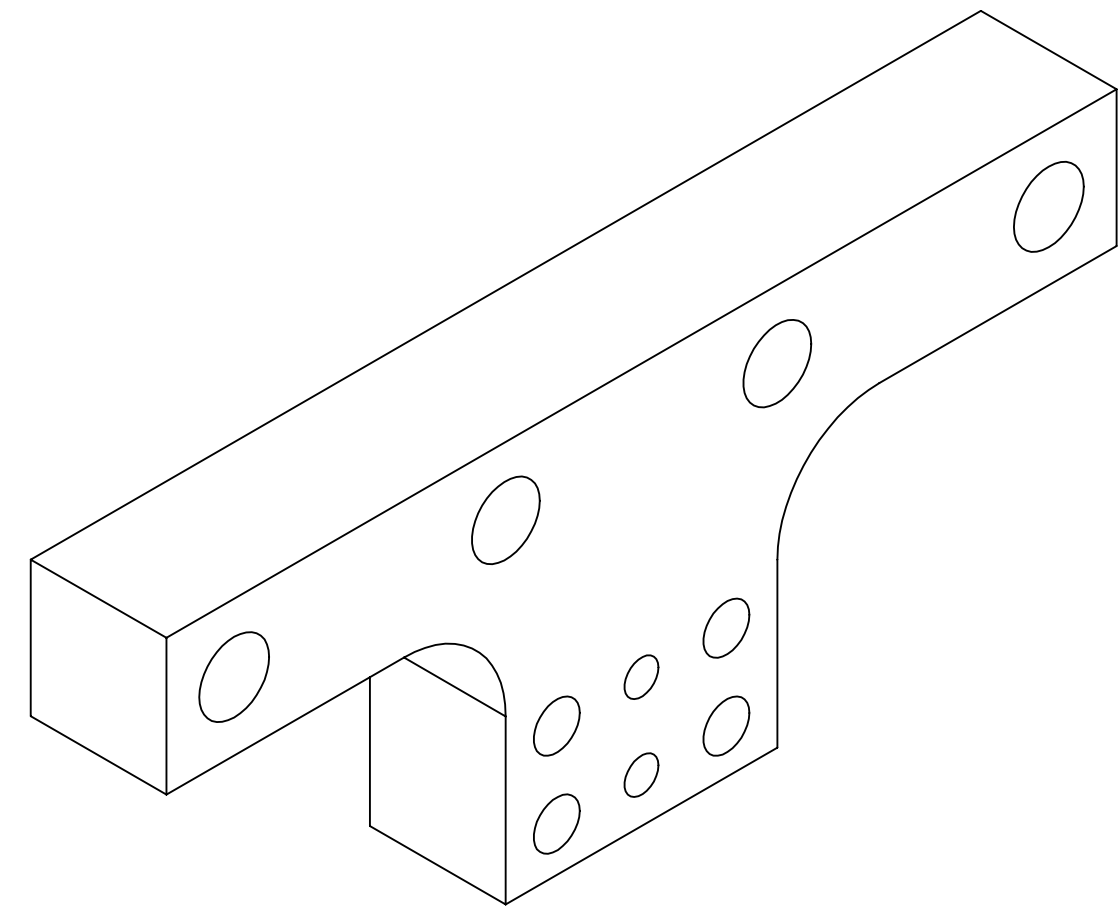

PROJECTED VIEW  
FOR REFERENCE ONLY  
DO NOT SCALE

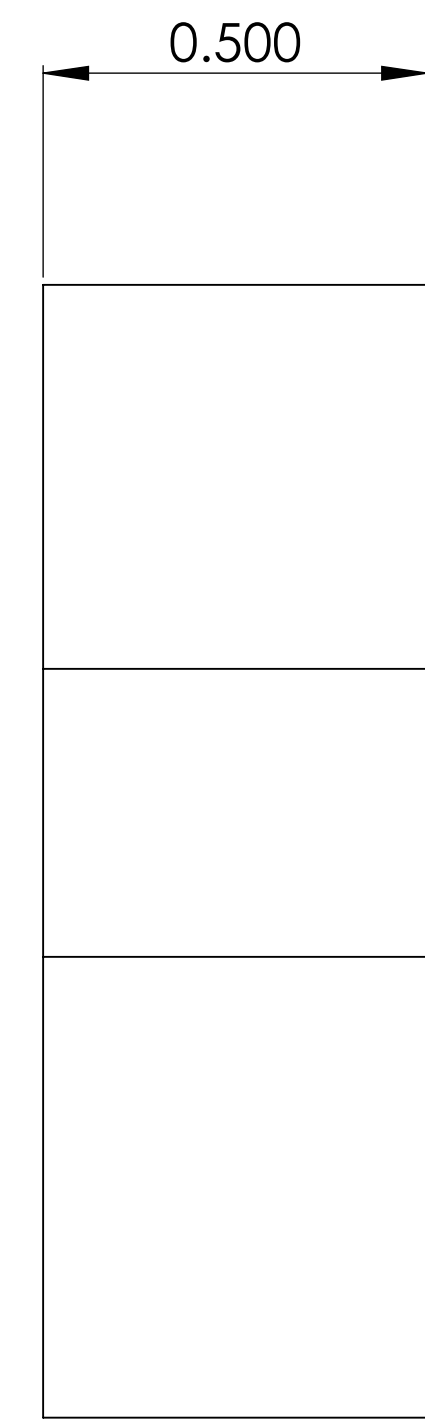
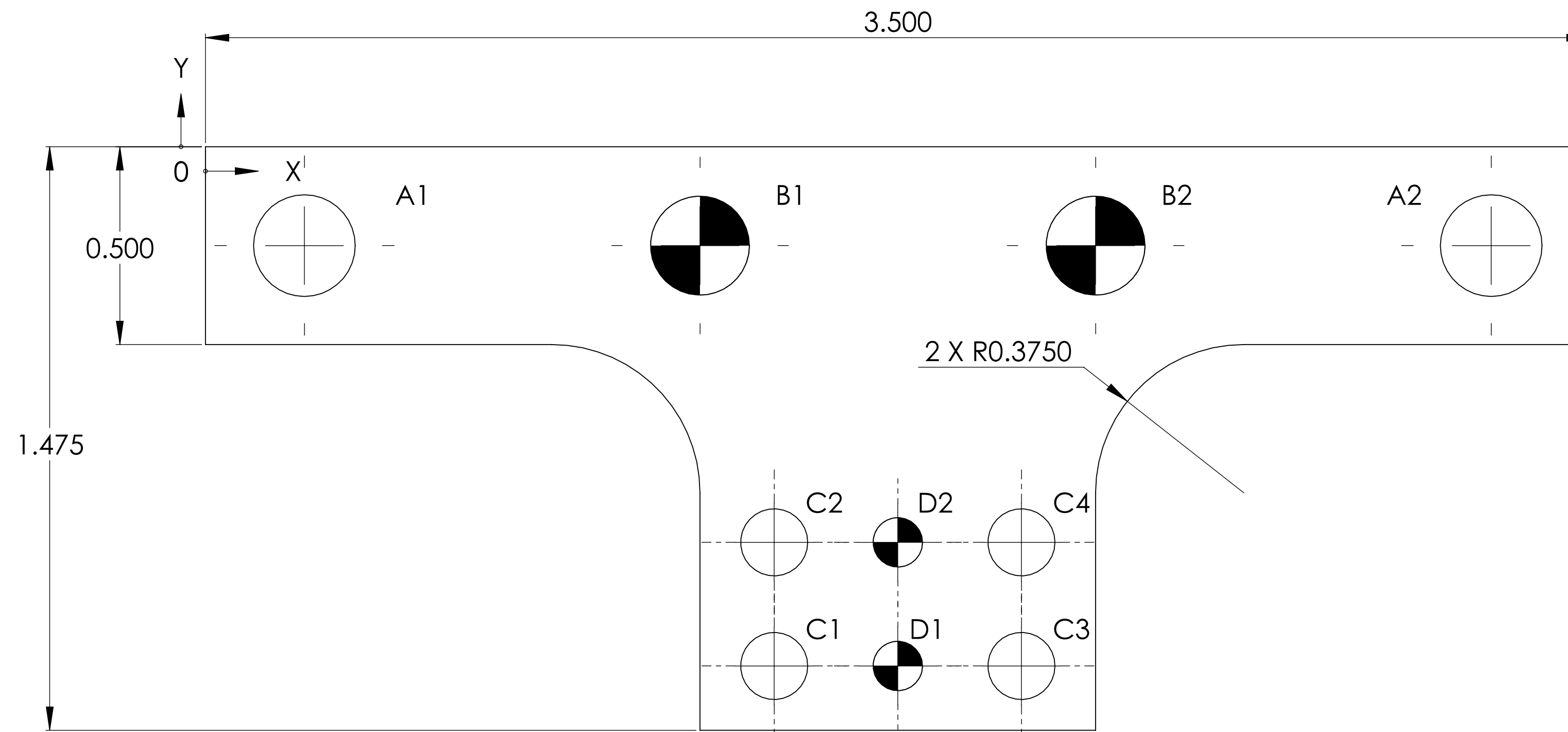

TAG	X LOC	Y LOC	SIZE
A1	0.250	-0.250	Ø 0.257 √ 1.500
A2	3.250	-0.250	Ø 0.257 √ 1.500
B1	1.250	-0.250	Ø 0.250 √ 1.500
B2	2.250	-0.250	Ø 0.250 √ 1.500
C1	1.438	-1.312	Ø 0.170 √ 1.500
C2	1.438	-1.000	Ø 0.170 √ 1.500
C3	2.063	-1.312	Ø 0.170 √ 1.500
C4	2.063	-1.000	Ø 0.170 √ 1.500
D1	1.750	-1.312	Ø 0.125 √ 1.500
D2	1.750	-1.000	Ø 0.125 √ 1.500

2. ALIGN USING DOWELL PINS
1. REMOVE ALL BURRS AND SHARP EDGES .003 TO .010

NOTES: UNLESS OTHERWISE SPECIFIED

		UNLESS OTHERWISE SPECIFIED DIMENSIONS ARE IN INCHES TOLERANCES DECIMALS .XX" ± .03 ANGLES ±1/2 .XXX" ± .010		CONTRACT NO		<b>Folkers E. Rojas UROP Production</b> <i>Massachusetts Institute of Technology</i> <i>Boston, MA 02139</i>	
		MACHINE FINISH 32 DO NOT SCALE DRAWING INTERPRET DWG BY ISO		APPVD F.E. Rojas DATE			
		MATERIAL AL 6061 USE CAST AL		DWN		<b>POETS on IRTF</b> <b>Interior Hardware: Optic 2 Stand</b> <b>Vertical</b>	
		APPLICATION		CHK			
				STRCT		SCALE D	
				MATL		CAGE NO 10-019	
				THRM CONT		FILE: PART	
				ENGR		REV B	
				DSGN SUPV		SCALE 4/1 UNCLASSIFIED	

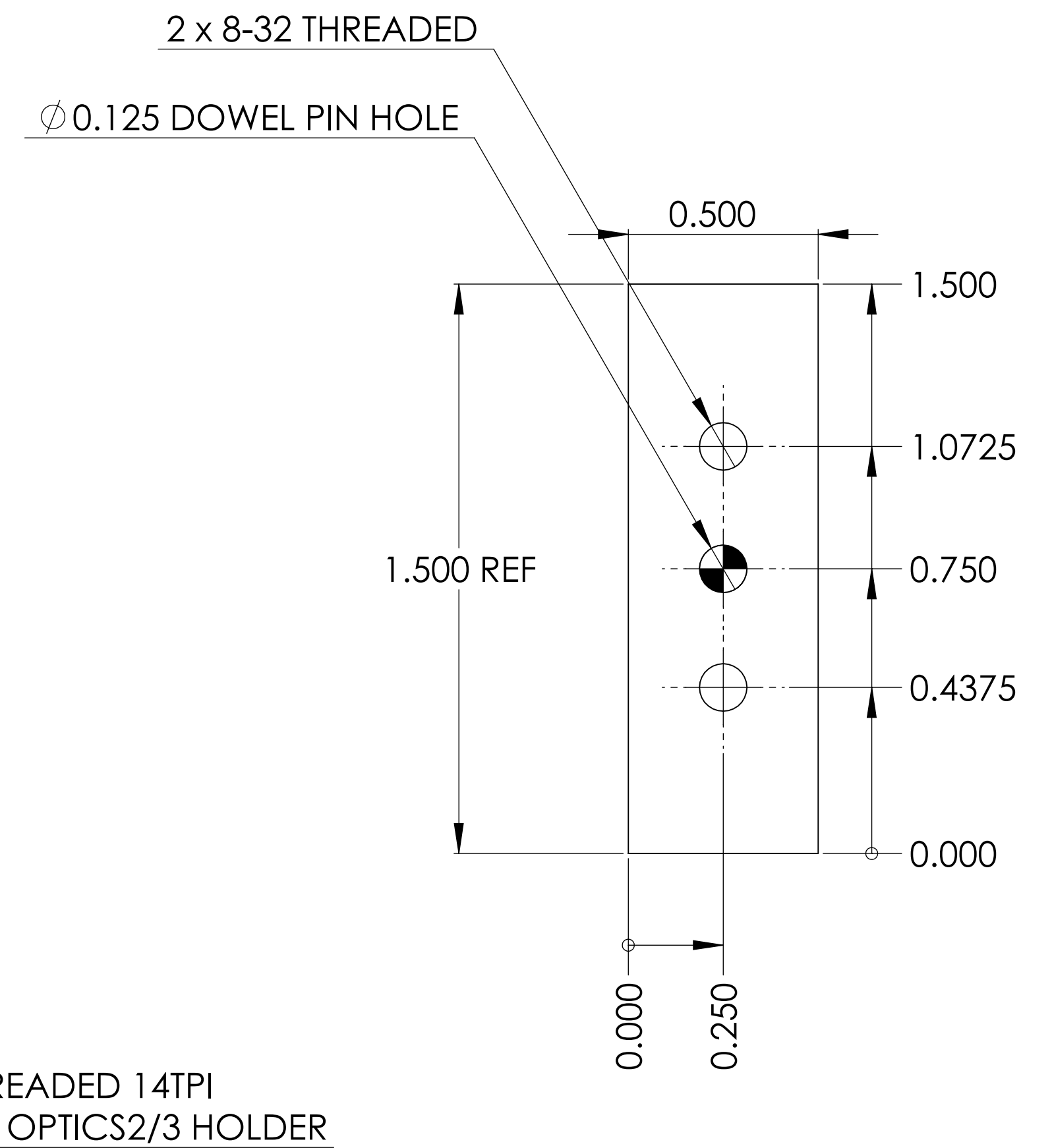
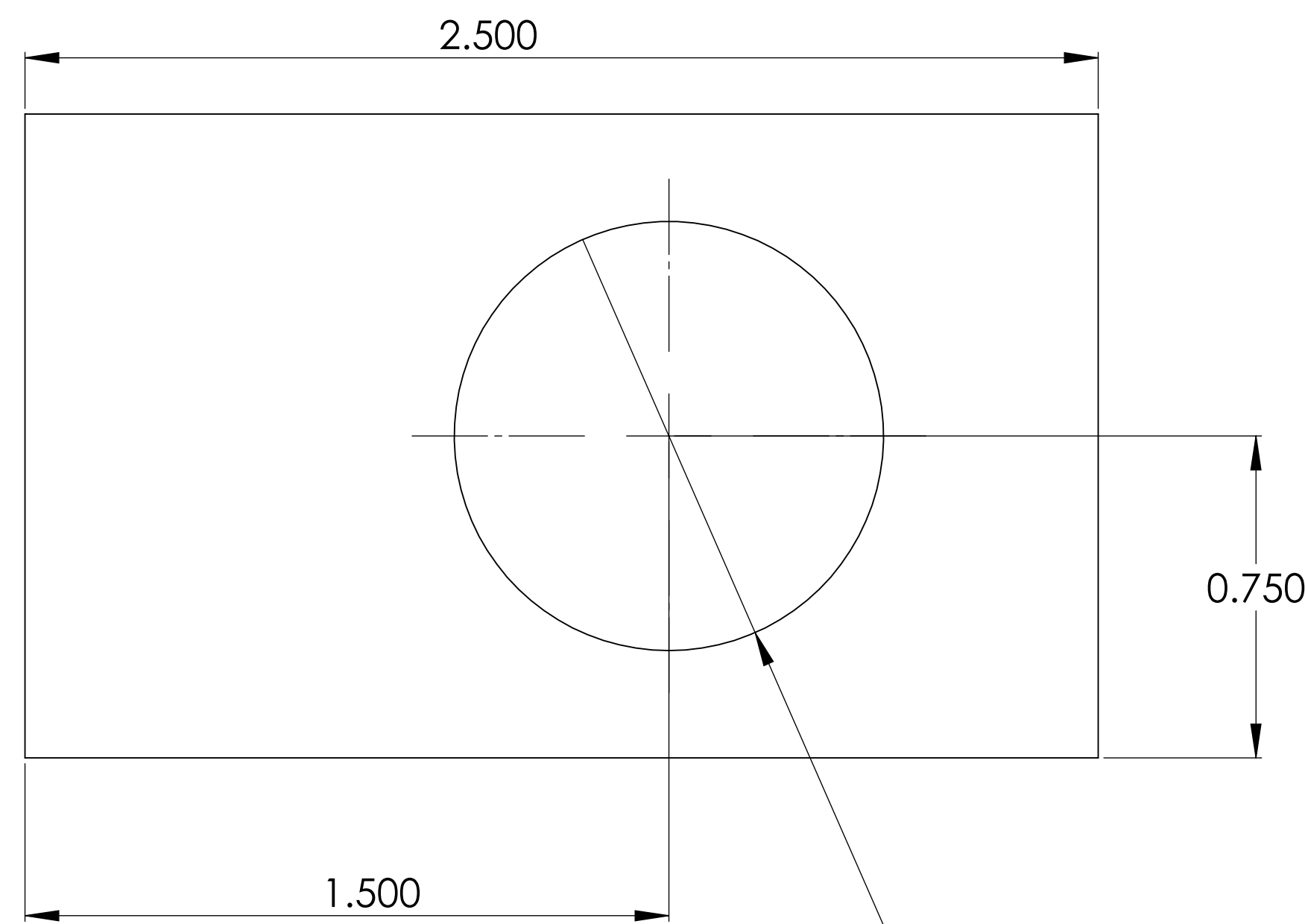
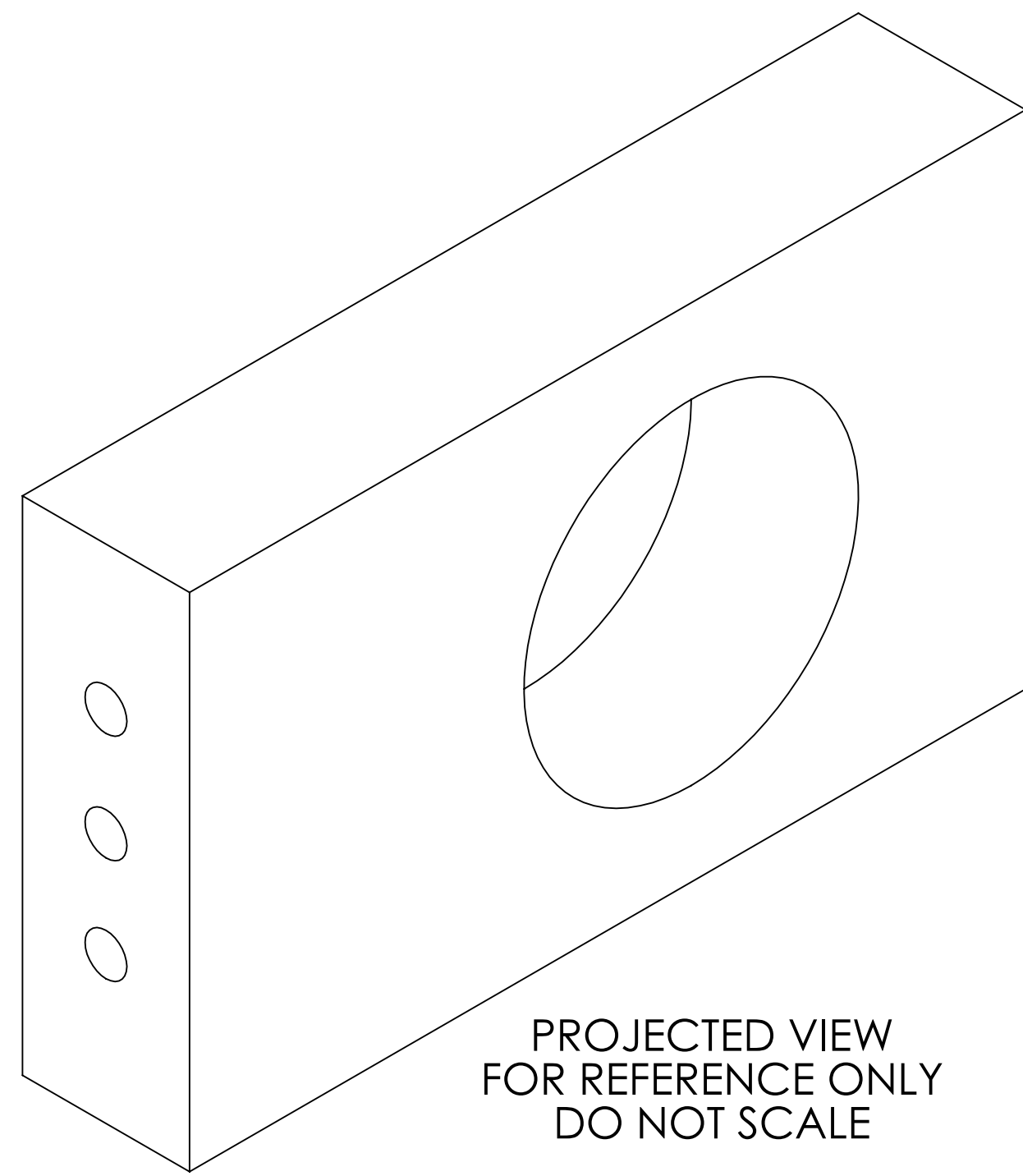

2. REMOVE ALL BURRS AND SHARP EDGES .003 TO .010

1. OUTER THREAD MADE TO FIT WITH PART 10-024

NOTES: UNLESS OTHERWISE SPECIFIED

		UNLESS OTHERWISE SPECIFIED DIMENSIONS ARE IN INCHES TOLERANCES DECIMALS .XX" ± .03 ANGLES ±1/2 .XXX" ± .010		CONTRACT NO		<b>Folkers E. Rojas UROP Production</b> <i>Massachusetts Institute of Technology</i> <i>Boston, MA 02139</i>	
		MACHINE FINISH 32/ DO NOT SCALE DRAWING INTERPRET DWG BY ISO		APPVD F.E. Rojas DATE			
		MATERIAL AL 6061 USE CAST AL		DWN		<b>POETS on IRTF</b> <b>Interior Hardware: Optic 2</b> <b>Stand Horizontal</b>	
				CHK			
				STRCT		SCALE D CAGE NO 10-020-B FILE: PART REV B	
				MATL			
				THRM CONT		SCALE 3/1 UNCLASSIFIED	
				ENGR			
APPLICATION				DSGN SUPV			